

SEA CLOUD: Cabin Categories

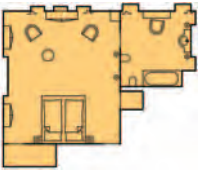

Luxury Suite, Original Owner's Cabin No. 1 (Cat. A)

A marble fireplace, Louis-Philippe chairs, and the double bed in antique white lacquer decorate the 38 m² suite with walk-in closet. The 38 m² marble bathroom features a bathtub, sink with golden swan fixtures, and an antique dressing table.



De Luxe Original Cabin No. 8 (Cat. B)

This apricot-hued cabin is 25 m². In addition to a king-size bed, antique pieces and grey-beige marble in the 6 m² bathroom lend an elegant style. A walk-in closet and pullman bed is part of the configuration.



Luxury Suite, Original Owner's Cabin No. 2 (Cat. A)

A maple-paneled living area, marble fireplace, grand bathroom, and large, walk-in closet. Mr. Hutton's suite is 34 m². The bathroom, done in red Carrara marble, is 9 m² and features a bathtub, sink, and dresser.

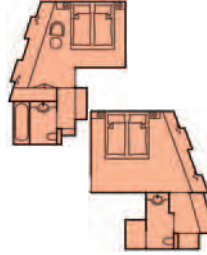

De Luxe Outside Cabins No. 9 and 10 (Cat. B)

These two contemporary, elegant cabins once housed the nanny and tutor of the owner's daughter. Cabin No. 9 measures 20 m² and has a marble bathroom with a tub. The 18,5 m² Cabin No. 10 is equipped with a shower. Both cabins have walk-in closets and ample storage space. They are located at the end of the hall and have their own staircase to the Promenade Deck.



De Luxe Original Cabin No. 3 (Cat. B)

A green-grey marble bathroom, a walk-in closet, antique single beds, two stylish chairs, a mirrored dresser, and a desk give this 24 m² room its colonial flair. The bathroom, with tub, measures 4 m².



De Luxe Original Cabin No. 4 (Cat. B)

Styled after a room in an English manor, this 22 m² cabin features carefully chosen antiques. It also has a large walk-in closet and a 5 m² bathroom with tub.

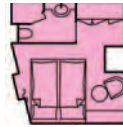

Double Bed Cabins No. 30, 31 (Cat. 1)

These two 13 m² cabins on the Captain's and Lido Deck have a corner panorama window and elegant bathrooms with showers.



De Luxe Original Cabin No. 5 (Cat. B)

With mahogany dressers, a marble bathroom and fireplace, antique furnishings, and a large, walk-in closet, this cabin of 20 m² offers comfortable elegance. Its 5,4 m² marble bathroom is equipped with a tub.

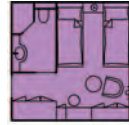

Twin Bed Cabins No. 32-37 (Cat. 2)

Both 13,5 m² cabins have two single beds, panorama windows, and bathrooms fitted with showers. They are located on the Captain's Deck.



De Luxe Original Cabin No. 6 (Cat. B)

Warm, bright, light colors create the joyful atmosphere of this 18 m² cabin with its ornate antique furniture and marble fireplace. It also has a walk-in closet and a 4 m² bathroom with a shower.

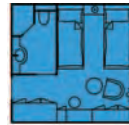

Twin Bed Cabins No. 18-25 (Cat. 3)

These 12,5 m² cabins on the Promenade Deck are furnished similarly to cabins No. 32-37.

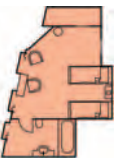

De Luxe Original Cabin No. 7 (Cat. B)

The owner's daughter, Dina, made it a habit to sleep in this 24 m², comfortable cabin furnished with maple furniture, a fireplace, and a walk-in closet. The 7 m² marble bathroom sports a tub with golden fixtures.

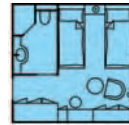

Twin Bed Cabins No. 28, 29 (Cat. 4)

These 10,5 m² cabins on the Promenade Deck are furnished similarly to cabins No. 32-37.



Upper/Lower Bed Cabins No. 14-17 (Cat. 5)

These 9,5 m² cabins that once housed the ship's officers exude a maritime charm. They are fitted with upper and lower single beds.

SEA CLOUD II: Cabin Categories



Owner's Suites No. 401, 402 (Cat. A)

The two 27 m² Owner's Suites located on the Lido Deck feature panorama windows, a fireplace, a canopied king bed, four closets, TV with video, a minibar, and a safe. Spacious marble bathrooms are outfitted with a bathtub, a shower, and a sink.



De Luxe Double Bed Cabins No. 218-223 (Cat. D)

Six Deluxe Double Bed Cabins, at 19 m², are located mid-ship on the Cabin Deck. They have portholes, a queen bed, a seating area, a closet, TV with video, a minibar, and a safe. The 3 m² bathrooms feature a shower, and a marble sink.



Junior Suites No. 303-319 (Cat. B)

Junior Suites, on the Promenade Deck, are 23 m² and feature panorama windows, a queen bed, a fireplace, a separate seating area, a walk-in closet, TV with video, a minibar, and a safe. Marble bathrooms have a tub with shower, and a marble sink.



De Luxe Double Bed Cabins No. 207-217, 224-231 (Cat. E)

The 16 m² Deluxe Double Bed Cabins with portholes include a queen bed with two separate mattresses, a seating area, a closet, TV with video, a minibar, and a safe. The 3 m² bathrooms are equipped with a shower, and a marble sink.

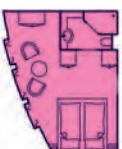

De Luxe Double Bed Cabins No. 301 and 302 (Cat. C)

Two 20 m² Deluxe Double Bed Cabins at the bow of the ship on the Promenade Deck feature panorama windows, a queen bed with two separate mattresses, a separate seating area, a closet, TV with video, a minibar, and a safe. The 3 m² marble bathrooms have a shower, and a marble sink.

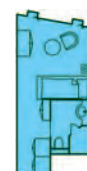

Upper/Lower Bed Cabins No. 204-206 (Cat. F)

These 12 m² cabins have upper and lower single beds and are especially suited for those traveling alone. They have a small seating area, a closet, TV with video, a minibar, and a safe. The 3 m² bath has a shower, and a marble sink.

SEA CLOUD: Deck Plan and Technical Data

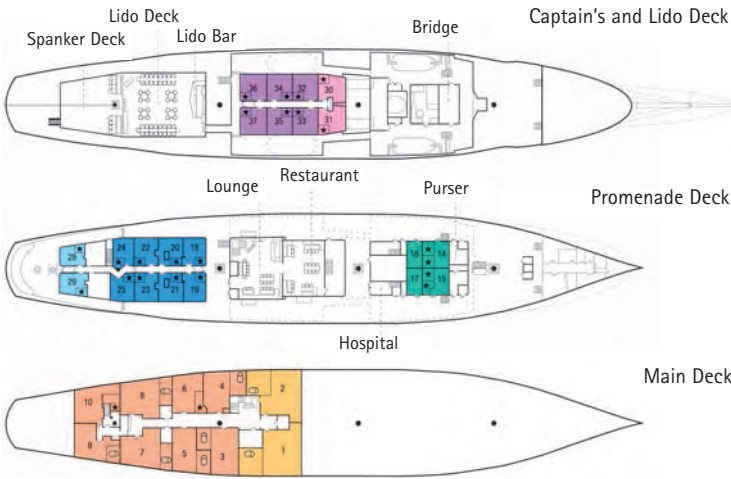

- Length overall: 109,50 m
- Beam: 14,94 m
- Draft: 5,13 m
- Main mast height above deck: 54,20 m
- Total sail area: 3.000 m²
- Number of sails: 30
- Passengers max.: 64
- Crew approx.: 60
- 32 outside cabins; of those, 10 cabins are original with marble bath, shower/WC, bathrobes, hairdryer, telephone, individually adjustable A/C, and an in-room safe
- Lido Deck with bar
- Dining room with open seating
- Lounge with desk area and laptop
- Infirmary
- Flag: Malta
- Year of construction: 1931
- ★ These cabins have a shower and WC
- ◻ These cabins have a bath, shower and WC
- Masts

- Cat. A: Luxury Owner's Cabin
- Cat. B: Deluxe Original Cabin
- Cat. 1: Outside Cabin N° 30, 31 Double Bed
- Cat. 2: Outside Cabin N° 32-37 Twin Bed
- Cat. 3: Outside Cabin N° 18-25 Twin Bed
- Cat. 4: Outside Cabin N° 28, 29 Twin Bed
- Cat. 5: Outside Cabin N° 14-17 Upper and Lower Bed



SEA CLOUD II: Deck Plan and Technical Data

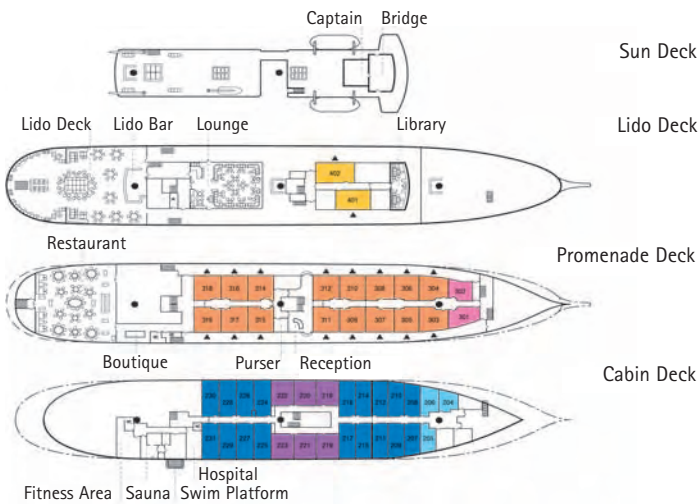

- Cat. A: Luxury Owner's Cabins
- Cat. B: Junior Suites
- Cat. C: Deluxe Double-Bed Cabins
- Cat. D: Deluxe Double-Bed Cabins
- Cat. E: Deluxe Double-Bed Cabins
- Cat. F: Upper/Lower Bed Cabins
- ▲ These cabins have a bathtub/shower as well as a walk-in closet
- Masts

- Length overall: 117 m
- Beam: 16 m
- Draft: 5,40 m
- Main mast height above deck: 48 m
- Total sail area: 2.800 m²
- Number of sails: 24
- Passengers max.: 94
- Crew approx.: 58
- 47 outside cabins, of those 16 Junior Suites and 2 Owner's Suites with shower/WC (suites with tubs), bathrobes, hairdryer, telephone, individually controlled A/C, private safe, TV/video, and minibar
- Lido Deck with bar
- Dining room with open seating
- Lounge, boutique, library, sauna, fitness area, swim platform
- Infirmary
- Flag: Malta
- Year of construction: 2001

